

- Dimensions are in millimeters, unless stated otherwise.  
 - Scaling of this drawing is not recommended.  
 - It is the recipient's responsibility to print this document to the correct scale.  
 - All relevant drawings and specifications should be read in conjunction with this drawing.



| Schedule of Accommodation |   |  |
|---------------------------|---|--|
| Total GIA                 | - | 50,000 ft <sup>2</sup> (4,645 m <sup>2</sup> ) |
| Site Area                 | - | 2.23 acres 0.90 ha                             |
| Site Density GIA          | - | 51.42%   |

| Unit 110                    |   |  |
|-----------------------------|---|--|
| Warehouse Area              | - | 22,500 ft <sup>2</sup> (2,090 m <sup>2</sup> )     |
| Office Area (excl. GF core) | - | 2,500 ft <sup>2</sup> (232 m <sup>2</sup> )        |
| <b>Unit 110 GIA</b>         | - | <b>25,000 ft<sup>2</sup> (2,323 m<sup>2</sup>)</b> |

| Unit 120                    |   |  |
|-----------------------------|---|--|
| Warehouse Area              | - | 22,500 ft <sup>2</sup> (2,090 m <sup>2</sup> )     |
| Office Area (excl. GF core) | - | 2,500 ft <sup>2</sup> (232 m <sup>2</sup> )        |
| <b>Unit 120 GIA</b>         | - | <b>25,000 ft<sup>2</sup> (2,323 m<sup>2</sup>)</b> |

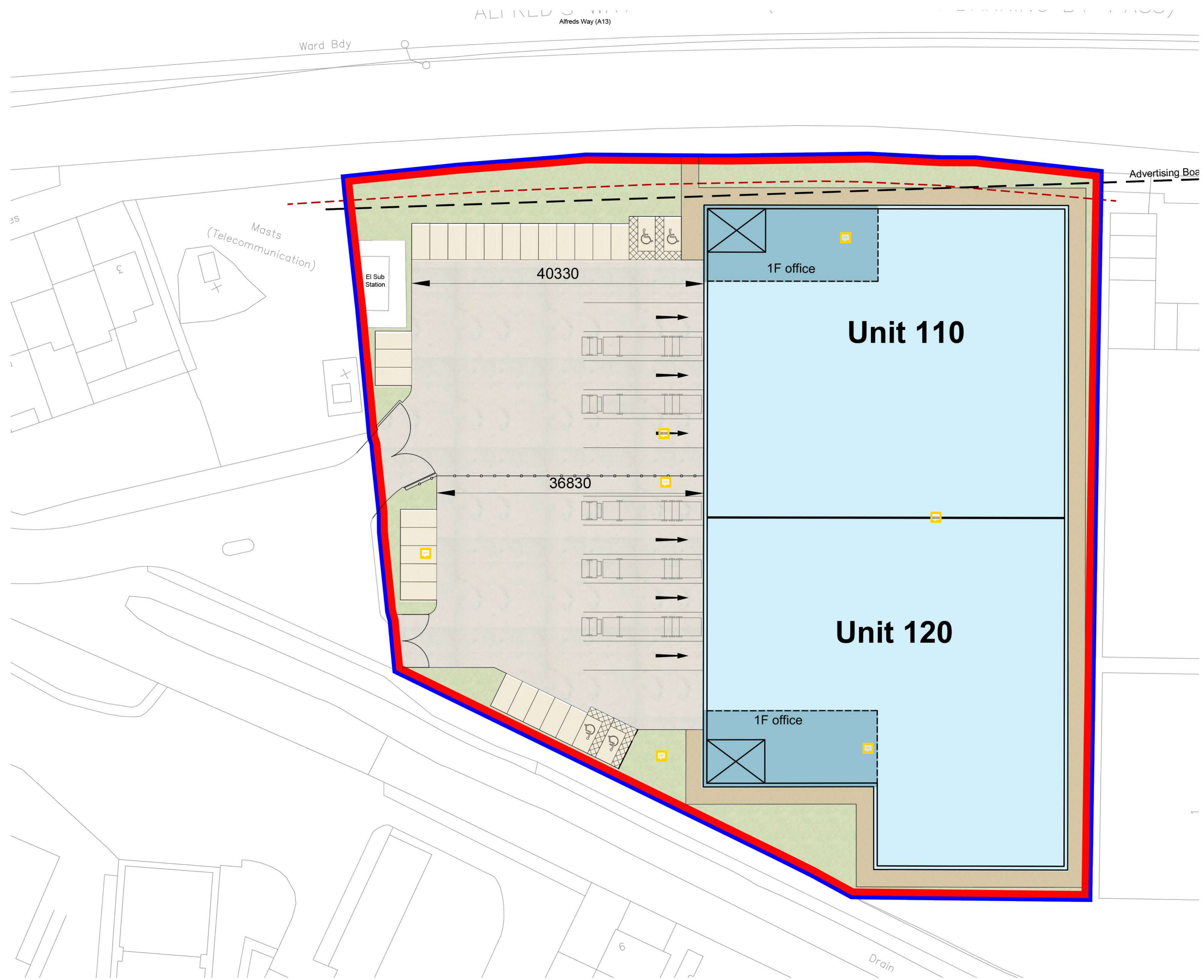

| rev | amendments | by | ckd | date |
|-----|------------|----|-----|------|
|     |            |    |     |      |

Alfreds Way, Barking

Site Layout

**GRAFTONGATE**



Newark Beacon, Cafferata Way, Newark, Nottinghamshire NG24 2TN  
 +44 (0)1636 653027 e. info@umcarchitects.com

|                       |                                       |
|-----------------------|---------------------------------------|
| RIBA PoW Stage:       | 3 - Spatial Coordination              |
| Document Suitability: | S1                                    |
| Drawn / Checked:      | JM / MRD                              |
| Date:                 | 28.02.2023                            |
| Scale:                | 1:250 A1                              |
| UMC Project Number:   | 21348                                 |
| Document Reference:   | 21348 - UMC - ZZZZ - SI - DR - A 0013 |
| Drawing no:           | 0013                                  |
| Revision:             | A                                     |