

SECTION A

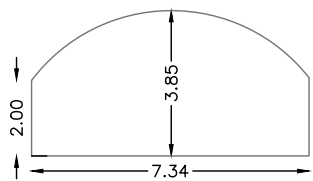

SECTION B

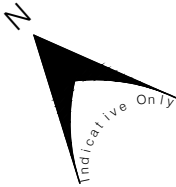
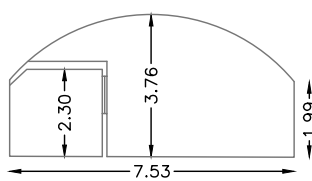

ACCESS ROAD

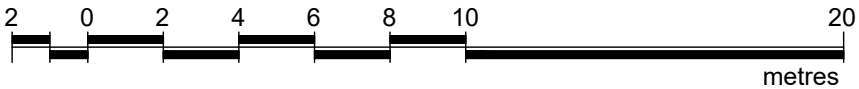
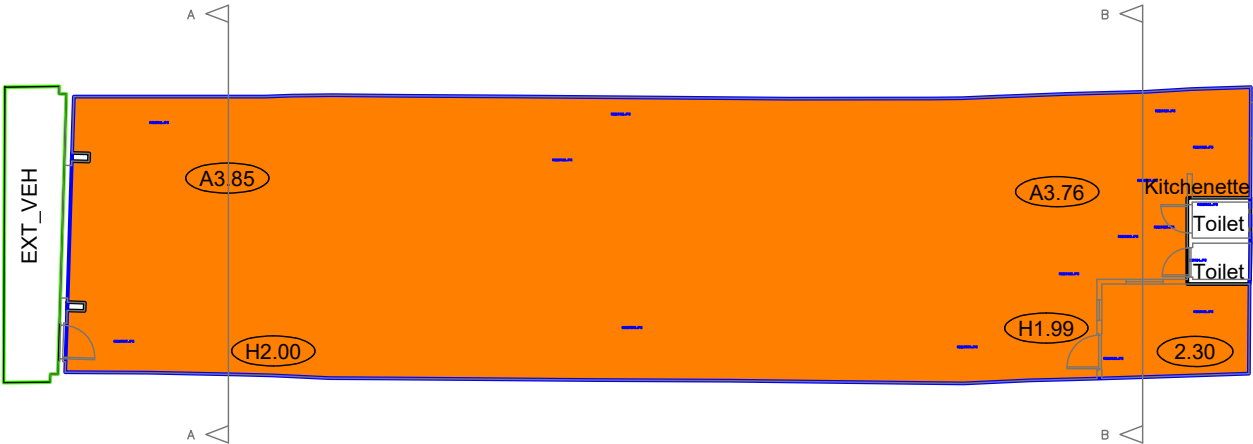

Presentation Scale 1:200 @ A3

Notes:
This drawing complies with the RICS Code of Measuring Practice, 6th edition (September 2007) and the Globally applicable 6th Edition (May 2015). It indicates the extent of the areas quoted, produced to an accuracy commensurate with standard presentation scales. It is held in a scaled digital CAD format.
Dashed lines denote assumed wall lines inaccessible or not in situ at the time of survey.

This drawing has been produced for area referencing purposes requested by the original commissioning agent and must not be used for any architectural or construction/engineering purposes or for any other purpose other than that for which it is originally intended. Plowman Craven Limited accepts no responsibility for details that are subsequently found to be the consequence of undisclosed facts or that were obscured from view at the time of survey or that have been altered since the date of survey.

This drawing contains Ordnance Survey data which has been reproduced with the permission of the Controller of Her Majesty's Stationery Office, Crown copyright 2020. The Ordnance Survey data has been obtained and reproduced by Plowman Craven Ltd in agreement with The Arch Company under Network Rail Licence Number 100040692.

- Legend:**
- (H0.00) Haunch Height (m)
 - (A0.00) Arch Maximum Height (m)
 - (0.00) Floor To Ceiling Height (m)

Revisions:
P01 - Original Issue (November 2020)

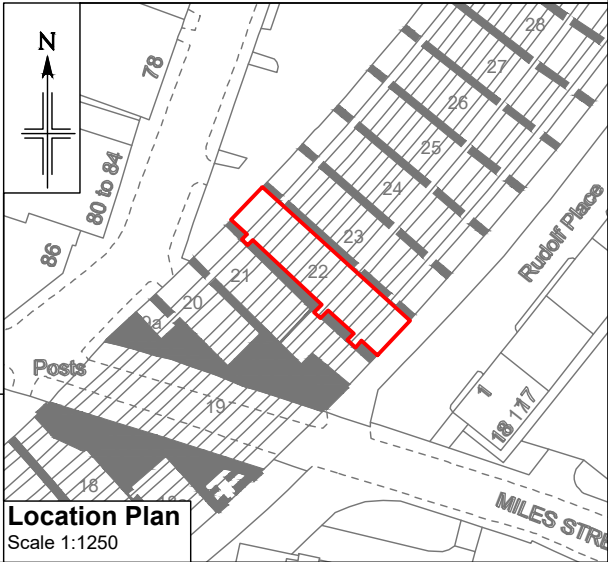

Property Ref: **VXH02900**

Arches Between Wandsworth Road
LONDON, SE11 5AW



Rental Space Ref: **VXH02904**

Arch 22 Miles Street, LONDON, SE11

Net Internal Area

	NIA	229.45 sq m	2470 sq ft
---	------------	--------------------	-------------------

The following have been EXCLUDED from the TOTAL NIA:

INT_OTH	4.00 sq m	43 sq ft
---------	-----------	----------

Gross Internal Area

	GIA	233.45 sq m	2513 sq ft
---	------------	--------------------	-------------------

Land Area

	LAND	11.88 sq m	128 sq ft
---	-------------	-------------------	------------------

The following have been INCLUDED in the TOTAL Land Area:

EXT_VEH	11.88 sq m	128 sq ft
---------	------------	-----------

Dwg No.
43264-PCL-VXH02904-GF-DR-G-00001_Master-S6-P01

Plowman Craven
Regulated by RICS

