

SECTION A

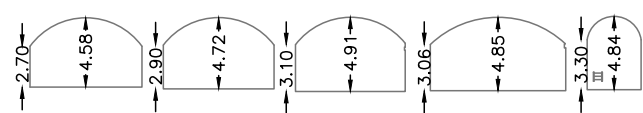

SECTION B

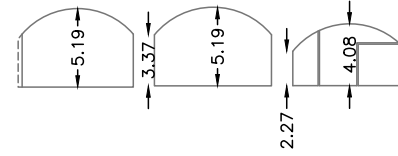

Property Ref: WAT08500

Arches btn Lambeth Road and LONDON, SE1 7EA



Rental Space Ref: WAT08529

Arches 200-202 & 200-203 & Yard Carlisle Lane, LONDON, SE1

Net Internal Area

**NIA** 1295.69 sq m 13947 sq ft

The following have been INCLUDED in the TOTAL NIA:

INT_RAI	10.38 sq m	112 sq ft
SLU_1	364.01 sq m	3918 sq ft
SLU_2	375.05 sq m	4037 sq ft
SLU_3	341.31 sq m	3674 sq ft
SLU_4	192.23 sq m	2069 sq ft
SLU_5	23.09 sq m	249 sq ft

The following have been EXCLUDED from the TOTAL NIA:

INT_OTH	53.81 sq m	579 sq ft
---------	------------	-----------

Gross Internal Area

**GIA** 1349.50 sq m 14526 sq ft

The following have been INCLUDED in the TOTAL GIA:

INT_PDB	31.76 sq m	342 sq ft
SLU_1	371.39 sq m	3998 sq ft
SLU_2	375.56 sq m	4042 sq ft
SLU_3	365.13 sq m	3930 sq ft
SLU_4	214.30 sq m	2307 sq ft
SLU_5	23.12 sq m	249 sq ft

The following have been EXCLUDED from the TOTAL GIA:

INT_TIS	8.41 sq m	91 sq ft
INT_TDE	22.92 sq m	247 sq ft

Land Area

**LAND** 1216.42 sq m 13093 sq ft

The following have been INCLUDED in the TOTAL Land Area:

EXT_COV	286.85 sq m	3088 sq ft
EXT_VEH	926.66 sq m	9974 sq ft
EXT_PED	2.91 sq m	31 sq ft

Dwg No. 43264-PCL-WAT08529-GF-DR-G-00001\_Master-S6-P01

**Plowman Craven**

Regulated by RICS



VIRGIL STREET

CARLISLE LANE

HERCULES ROAD

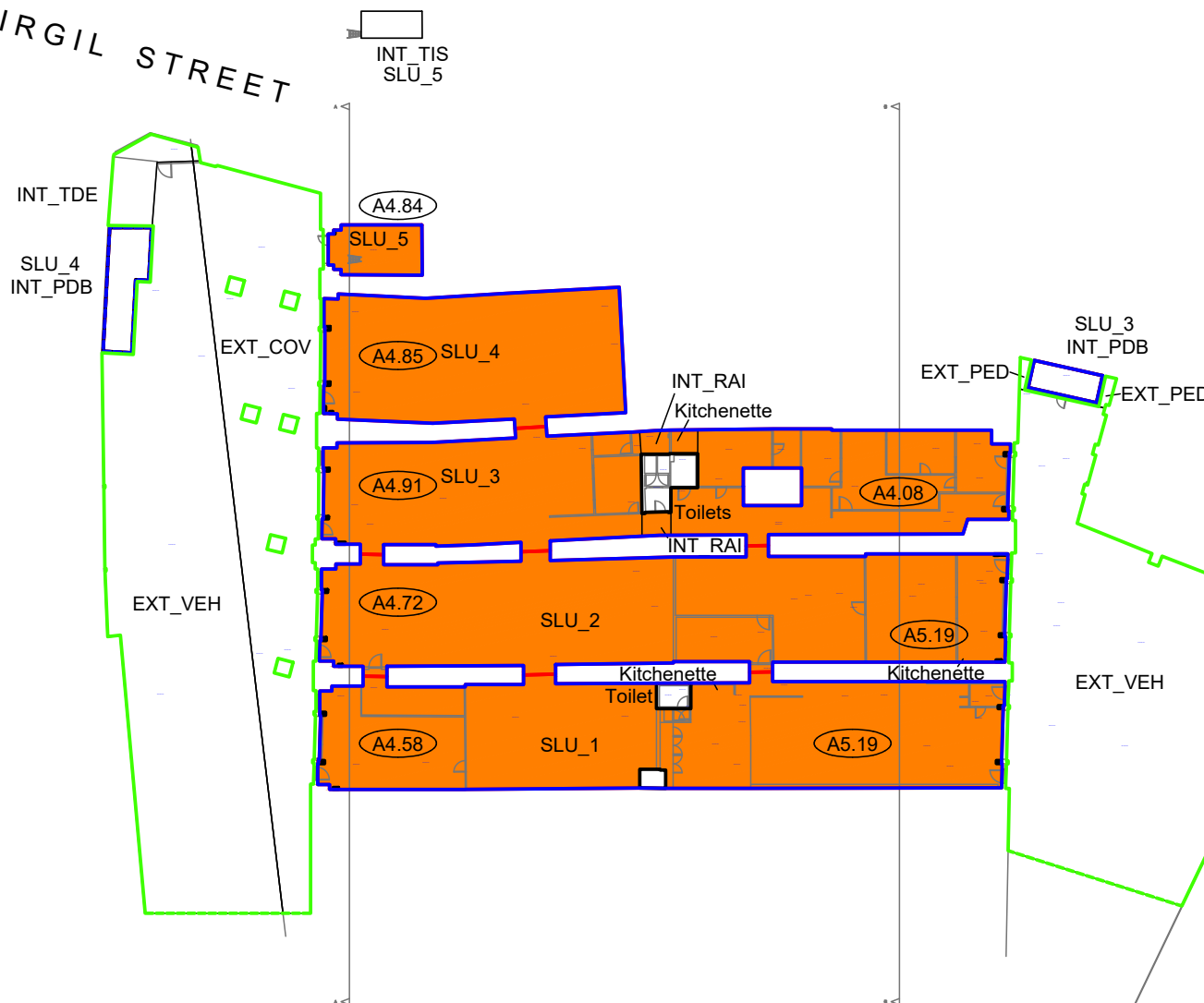

Presentation Scale 1:500 @ A3

**Notes:**  
This drawing complies with the RICS Code of Measuring Practice, 6th edition (September 2007) and the Globally applicable 6th Edition (May 2015). It indicates the extent of the areas quoted, produced to an accuracy commensurate with standard presentation scales. It is held in a scaled digital CAD format. Dashed lines denote assumed wall lines inaccessible or not in situ at the time of survey.

This drawing has been produced for area referencing purposes requested by the original commissioning agent and must not be used for any architectural or construction/engineering purposes or for any other purpose other than that for which it is originally intended. Plowman Craven Limited accepts no responsibility for details that are subsequently found to be the consequence of undisclosed facts or that were obscured from view at the time of survey or that have been altered since the date of survey.

This drawing contains Ordnance Survey data which has been reproduced with the permission of Her Majesty's Stationery Office, Crown copyright 2020. The Ordnance Survey data has been obtained and reproduced by Plowman Craven Ltd in agreement with The Arch Company under Network Rail Licence Number 100040692.

**Legend:**

	Single Lettable Unit
	Haunch Height (m)
	Arch Maximum Height (m)
	Floor To Ceiling Height (m)

**Revisions:**  
P01 - Original Issue (June 2021)

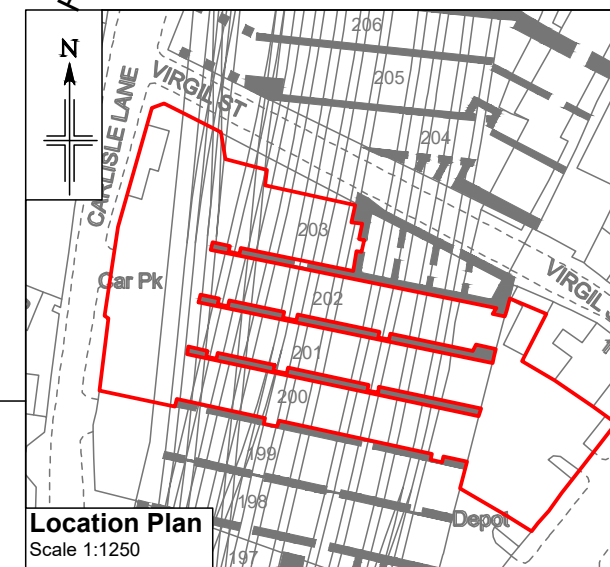

Location Plan  
Scale 1:1250