





# FULLY FITTED CONTEMPORARY OFFICE SPACE BY THE CROWN ESTATE



Located in the heart of St James's, Charles House is an exceptional office building. The available 1st and 6th floors each offer c.4,600 sq ft of workspace – which have been comprehensively refurbished and fully fitted to a high standard.

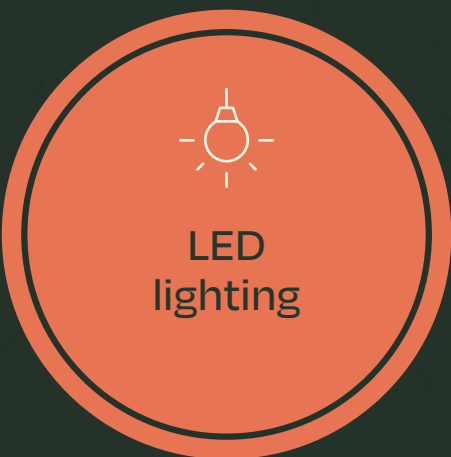

WITH  
ATTENTION  
TO EVERY  
DETAIL



# FIRST FLOOR



Flexible  
collaborative  
spaces





# FIRST FLOOR – HIGH QUALITY PLUG & PLAY WORKSPACE

The premier plug & play 1st floor has been refurbished to suit a range of occupiers, with bright open plan work space.

Offering 30 workstations in situ, there is the ability to add more desks to suit your needs.



## FIRST FLOOR – 4,627 SQ FT / 430 SQ M

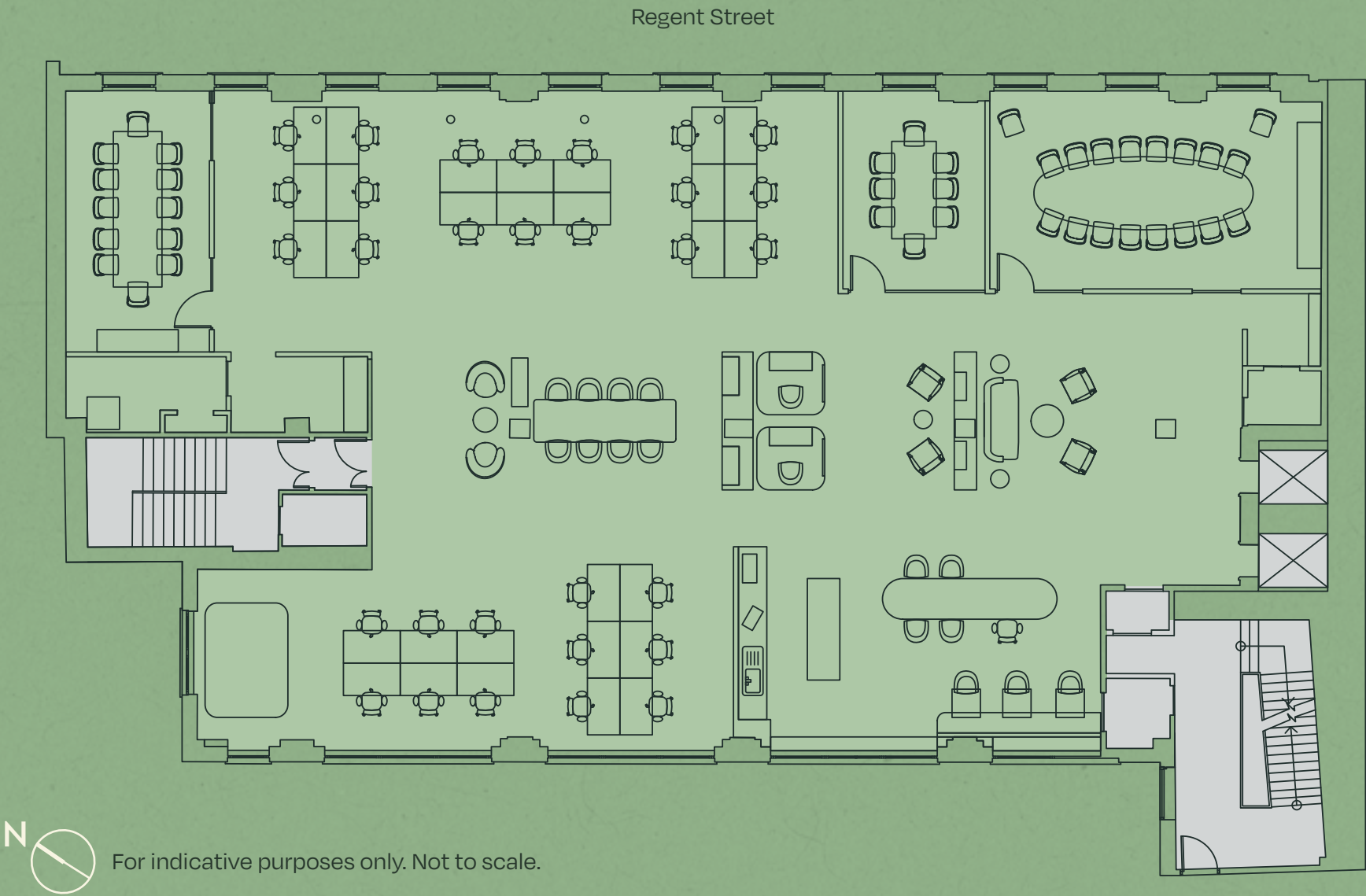

- 30 open plan desks
- 1 collaboration area
- 2 meeting rooms
- 1 x 16 person boardroom
- 2 phone booths
- Kitchenette
- Comms room





Fully fitted,  
ready to occupy



# SIXTH FLOOR





# SIXTH FLOOR – CONSIDERED WORKSPACE

The 6th floor has also been refurbished to offer fully fitted workspace, with a range of collaborative and breakout spaces including a kitchenette.



## SIXTH FLOOR – 4,586 SQ FT / 426 SQ M

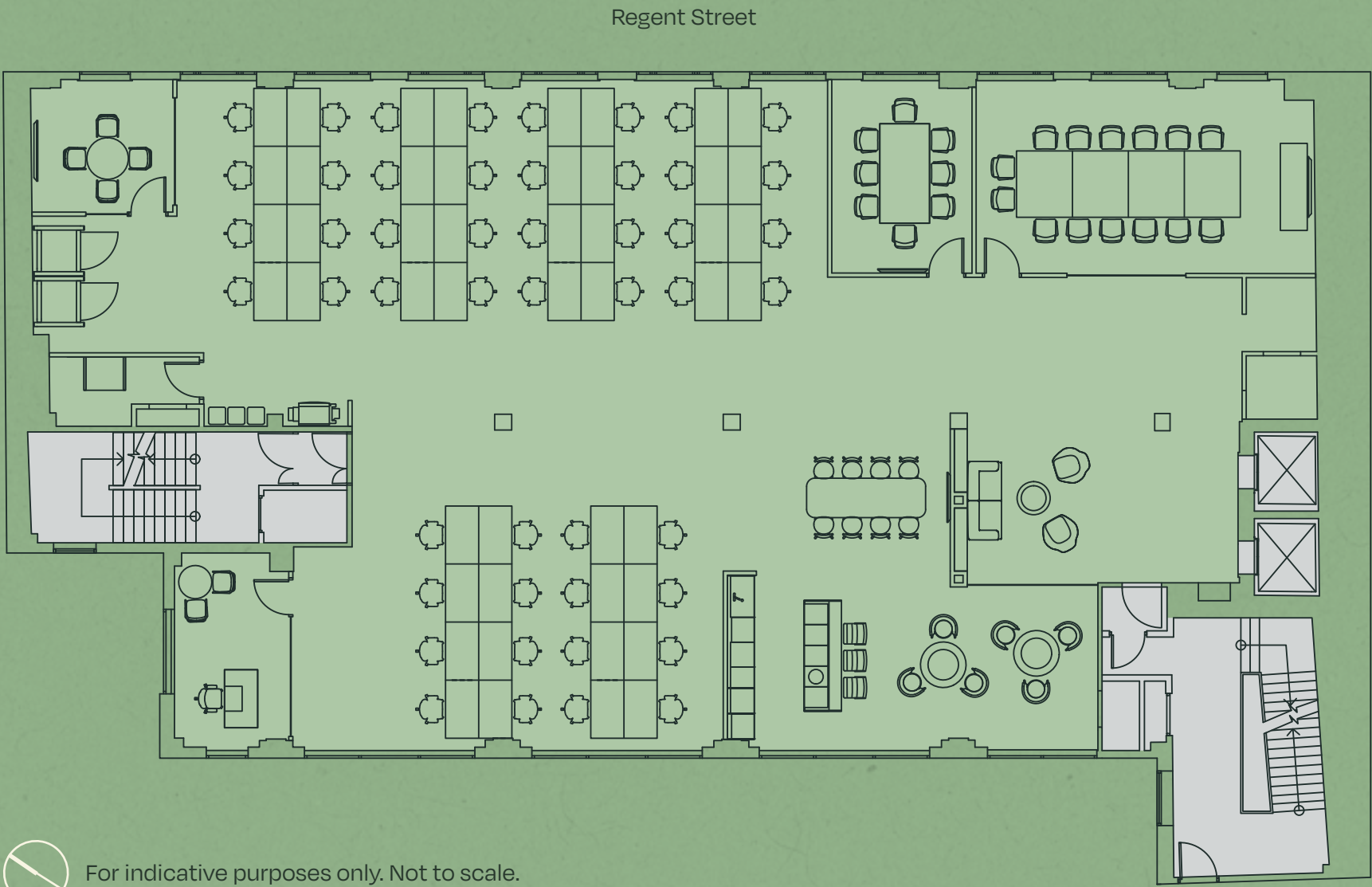

- 48 open plan desks
- 1 collaboration area
- 2 meeting rooms
- 1 x 14 person boardroom
- Private office
- 2 phone booths
- Kitchenette
- Comms room

N For indicative purposes only. Not to scale.





Charles House occupies a prominent position on Regent Street in St James's close to St James's Square.

The building is opposite St James's Market home to contemporary cafés, restaurants, and retail amenities.

The wider area continues to attract some of London's most prestigious retailers, galleries and private members club and is home to convenient lunch offerings and fine dining experiences.

ONE OF  
LONDON'S  
MOST DESIRABLE  
LOCATIONS





# THE PERFECT POSITION

The area continues to attract many highly regarded companies, drawn to the area thanks to the premium amenity offering and excellent transport connections.

Charles House is easily accessible with Piccadilly Circus station just a two-minute walk away (Bakerloo and Piccadilly lines), Charing Cross is just five minutes away offering access to mainline rail services and the Elizabeth line at Bond Street is also nearby offering reduced travel times across London.



St James's Park



St James's Square



## LOCAL AMENITIES

- |                       |                     |                           |
|-----------------------|---------------------|---------------------------|
| 01. Aspinal of London | 06. Sael            | 11. Ole & Steen           |
| 02. Café Murano       | 07. Fallow          | 12. Ambassadors Clubhouse |
| 03. Christie's        | 08. Fortnum & Mason | 13. Scully                |
| 04. Chutney Mary      | 09. Kingly Court    | 14. Farmer J              |
| 05. Claro London      | 10. O'Ver           | 15. Maison François       |

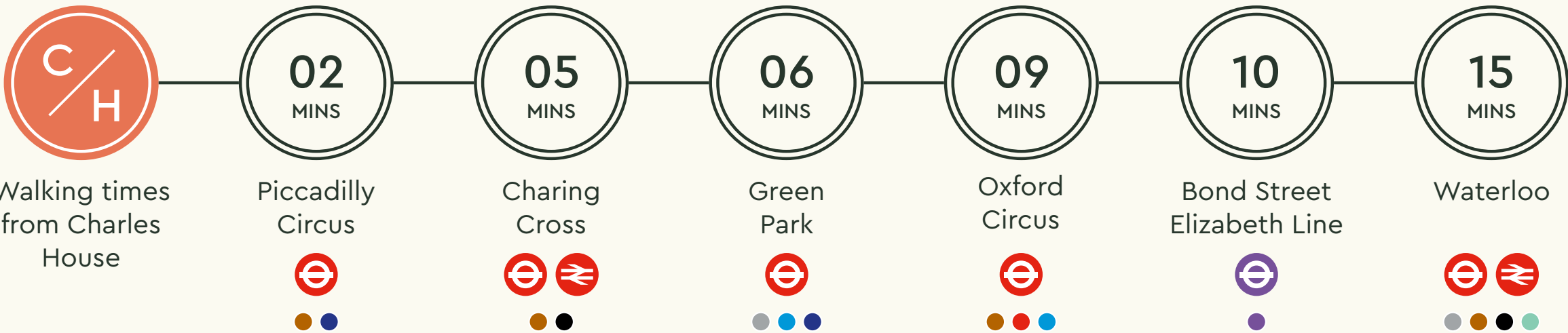



# INTRODUCING WORKPLACES+ BY THE CROWN ESTATE



**Delivering more than just office space.**

Workplaces+ gives you the flexibility to work your way. Enjoy access to collaborative workspaces, bookable meeting rooms, event space hire, wellbeing facilities, and a vibrant community of like-minded professionals. Plus, with its range of exclusive perks, from fitness classes to an on-site Community Team, Workplaces+ creates an office experience unlike any other.



**Workplaces+ Benefits**

- Access to fitness and wellbeing classes
- Access to talks and networking events
- Exclusive discounts for bookable meeting rooms
- St James's Office customers get free membership to 6 Babmaes
- 24/7 maintenance support
- 24/7 security
- Exclusive discounts for internal and external event spaces
- Bespoke perks and discounts around the portfolio

WORKPLACES+  
MAKING  
'WORK' WORK  
FOR YOU



# 6 BABMAES STREET



As a customer of The Crown Estate you will have privileged access to 6 Babmaes Street and the amenities it offers, including:

- Private meeting rooms at discounted rate
- Co-working space
- Business lounge & roof terrace
- Auditorium space



OUR NEW  
FLEXIBLE  
WORK SPACE  
HUB FOR  
WHEN YOU  
NEED SPACE



# FURTHER INFORMATION



**JAMES TAYLOR**

james.taylor@cushwake.com  
07899 843 767

**JOEL RANDALL**

joel.randall@cushwake.com  
07525 897 012



**SIMON TANN**

simon.tann@levyrealestate.co.uk  
07748 180 198

**MEGAN CARR**

megan.carr@levyrealestate.co.uk  
07896 899 798

Misrepresentation Act. These particulars are prepared for the guidance only of the prospective owners, tenants and occupiers. They are intended to give a fair overall description of the property but are not intended to constitute part of an offer or contract. Any information contained herein (whether in the text, plans or photographs) is given in good faith and should not be relied upon as being a statement or representation of fact. Nothing in these particulars shall be deemed to be a statement that the property is in good working condition or otherwise that any services or facilities are in good working order. Any areas, measurements or distances referred to herein are approximate only. Descriptions of a property are inevitably subjective and the descriptions contained herein are used in good faith as an opinion and not by way of statements or fact. Neither The Crown Estate nor any of its employees have any authority to make or give any warranty whatever in relation to this property. June 2025.